

ANATOMY OF THE ORIGINAL PEDDINGHAUS

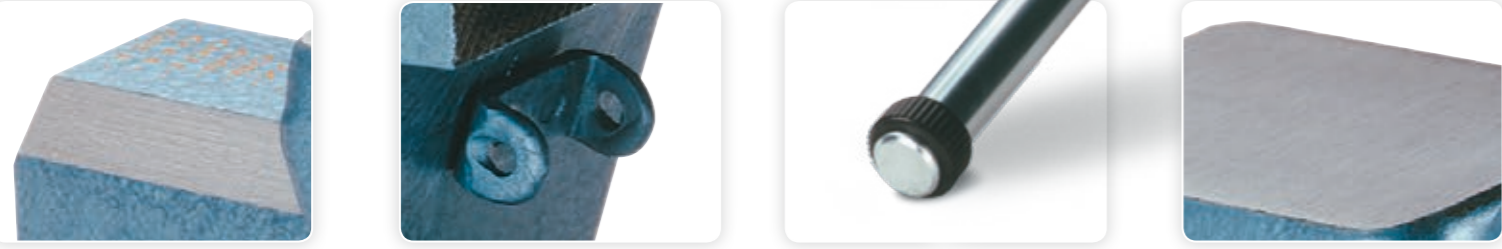

- 1** Measuring scale.
- 2** Long machined and surface guide bar for maximum precision.
- 3** Handle with changeable anti-pinch rubber rings to avoid accidents, increase lifetime and reduce noise.
- 4** Possibility to attach snap-on jaws, clamping securely and safely any type of workpiece. Superiors come with build-in pipe Jaws
- 5** Large hardened anvil for straightening and other forming work.
- 6** Hardened and serrated jaws for maximal durability. The Parallel Jaw Alignment System provides precise clamping and longer service life.
- 7** Removable steel spindle nut: Rolled twin start Acme thread for precise operation and longevity.
- 8** Spindle housing protecting the nut thread to be exposed to abrasive dust and other external materials.
- 9** Heat treated self-impeding adjustable guiding guarantee precise adjustments even after years.

GERMAN ORIGINAL SINCE 1903

RIDGID-PEDDINGHAUS BENCH VISE IS THE PERFECT TOOL FOR THOSE PROFESSIONALS WHO RELY ON THEIR BENCH VISE ON A DAILY BASIS.

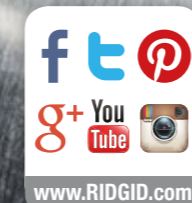

DISTRIBUTOR

RIDGID

Ridge Tool Europe
Schurhovenveld 4820
3800 Sint-Truiden
Belgium

Tel.: +32 (0)11 598 620
Fax: +32 (0)11 598 621
ridgid.eu@emerson.com
www.RIDGID.com

EMERSON

RIDGID

RIDGID
FULL LIFETIME WARRANTY
Against Material Defects & Workmanship

FORGED TO LAST GENERATIONS



PEDDINGHAUS

GERMAN ORIGINAL SINCE 1903



RIDGID® PEDDINGHAUS VISES
 RENOWNED FOR QUALITY AND DURABILITY,
 PRODUCED IN GERMANY FOR OVER
 110 YEARS.

*Der neue Schraubstock
 Ein Wunder der Technik*

PAUL FERD. PEDDINGHAUS
 GEVELSBERG

Renowned for quality and durability,
 produced in Germany for over 110 years.
 All bench vises are constructed of 75,000
 psi tensile strength forged steel, which
 is 3 times stronger than cast iron.



Vises

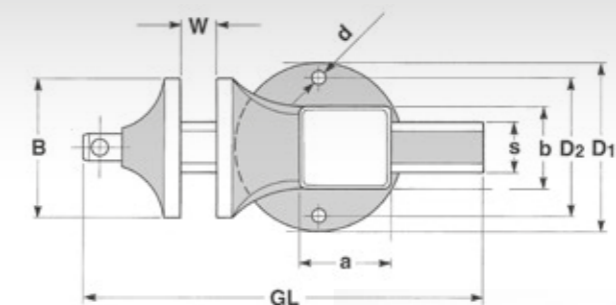

MULTIPLUS



- Professional multipurpose vise with bending and straightening attachment.
- Suitable for bending steel, stainless steel and hydraulic pipes and straightening steel strips.
- A force of 2,5 / 3,5 tons is applied by the spindle of the Multiplus 120 / 160, allowing bends of AISI 304 stainless steel pipe up to 22 / 28 mm with 1,5 mm wall thickness.
- Supplied complete and ready to use with 15 mm, 18 mm and 22 mm formers, straightening anvil and 2 corner supports.
- Its unique design and built-in quality features make it one of the most desirable handtools of the past decades. A real 3 in 1 tool capable of clamping, bending and straightening.

| Cat. No. | Model No. | Multiplus: Dimensions mm (see drawing) | | | | | | | | | Weight | |
|----------|-----------|--|-----|-----|----|-----------|-----|-----|----|------|--------|--|
| | | B | W | GL | S | axb | D1 | D2 | d | lb. | kg | |
| 35821 | 120 | 120 | 140 | 390 | 50 | 75 x 75 | 150 | 115 | 14 | 44.1 | 20.0 | |
| 15318 | 160 | 160 | 240 | 500 | 65 | 120 x 110 | 180 | 145 | 14 | 81.6 | 37.0 | |

Pionier Vises

PIONIER HINGED PIPE VISES



- Made from high grade cast iron.
- Replaceable hardened steel jaws.
- Rolled spindle thread.
- Available in three models (2" - 3" - 4").

PORTABLE WORKSTAND WITH PIPE VISE



- Pipe bending plate.
- Storage shelf for tools and hinged floor board for stability.
- Special safety lock stops workstand accidentally falling forward.

| Cat. No. | Model No. | Type | Capacity | | Weight | |
|----------|-----------|--------------|----------|----------|--------|------|
| | | | in. | mm | lbs. | kg |
| 11052 | 2 | Pionier Vise | 1/8 - 2 | 10 - 60 | 9.1 | 4.3 |
| 11053 | 3 | Pionier Vise | 1/8 - 3 | 10 - 89 | 3.6 | 6.5 |
| 11054 | 4 | Pionier Vise | 1/8 - 4 | 10 - 114 | 22.1 | 10.0 |

| Cat. No. | Model No. | Type | Capacity | | Weight | |
|----------|-----------|-------------------|----------|---------|--------|------|
| | | | in. | mm | lbs. | kg |
| 12202 | 2 | Pionier Workstand | 1/8 - 2 | 10 - 60 | 50.7 | 23.0 |
| 12203 | 3 | Pionier Workstand | 1/8 - 3 | 10 - 89 | 60.1 | 30.0 |

Model No. 2 bends 1/8" to 1 1/2" pipe. Model No. 3 bends 1" to 2" pipe.

MATADOR

Professional bench vise for the workshop.

| Cat. No. | Model No. | Pipe Capacity | Matador: Dimensions mm (see drawing) | | | | | | | | Weight | |
|----------|-----------|---------------|--------------------------------------|-----|-----|----|-----------|-----|-----|----|--------|------|
| | | | B | W | GL | S | axb | D1 | D2 | d | lb. | kg |
| 10803 | 100 | — | 100 | 125 | 270 | 36 | 65 x 60 | 120 | 90 | 11 | 13.0 | 6.0 |
| 10804 | 120 | — | 120 | 150 | 340 | 50 | 75 x 70 | 150 | 115 | 14 | 22.0 | 10.0 |
| 10805 | 140 | — | 140 | 200 | 440 | 55 | 95 x 90 | 180 | 145 | 14 | 39.7 | 18.0 |
| 10806 | 160 | — | 160 | 225 | 500 | 65 | 120 x 110 | 180 | 145 | 14 | 55.2 | 25.0 |
| 10807 | 180 | — | 180 | 225 | 500 | 65 | 120 x 110 | 180 | 145 | 14 | 57.4 | 26.0 |

SUPERIOR

Professional vise with built-in pipe jaws for the installation industry.

| Cat. No. | Model No. | Pipe Capacity | Superior: Dimensions mm (see drawing) | | | | | | | | Weight | |
|----------|-----------|---------------|---------------------------------------|-----|-----|----|-----------|-----|-----|----|--------|------|
| | | | B | W | GL | S | axb | D1 | D2 | d | lb. | kg |
| 10814 | 120 | 3/8" - 3" | 120 | 150 | 340 | 50 | 75 x 70 | 150 | 115 | 14 | 22.0 | 10.0 |
| 10815 | 140 | 1/2" - 3 1/2" | 140 | 200 | 440 | 55 | 95 x 90 | 180 | 145 | 14 | 39.7 | 18.0 |
| 10816 | 160 | 1/2" - 4" | 160 | 225 | 500 | 65 | 120 x 110 | 180 | 145 | 14 | 55.2 | 25.0 |

Accessories



SNAP-ON JAWS



360° SWIVEL BASES



PEDDI-LIFT



ELEVATORS



CLAMPING SCREWS

Anvils

RIDGID® Peddinghaus anvil has long stood for quality and craftsmanship. Peddinghaus anvils are drop-forged and produced entirely from high grade steel for maximum durability. The top face is ground and hardened to provide a lively surface to work on.

| Twin Horn anvil - Model No. | 5 | 9 | 12 |
|-----------------------------|--------------|-----------|-----------|
| Cat. No. | 14165 | 14169 | 14190 |
| Weight | lb. 77.2 | 165.4 | 275.5 |
| | kg 35 | 75 | 125 |
| Width of face | mm 95 | 125 | 130 |
| Length of face | mm 205 | 265 | 300 |
| Length of each horn | mm 135 | 185 | 210 |
| Total length | mm 475 | 635 | 720 |
| Total height | mm 200 | 265 | 310 |
| Base | mm 170 x 195 | 235 x 275 | 270 x 345 |

